



Construction Notice

December 20, 2023

ERIN SEWAGE PUMPING STATION

Contract: 2022-03W

The Town will be constructing a Sewage Pumping Station in the Lions' Club Park in Erin Village as part of the Council-approved Erin Wastewater Servicing Project.

Construction will start in early January 2024 with the contractor preparing the site. This work will include erecting fencing along the perimeter of the site, site grading and set-up of the site trailers, as shown in the map below.

All trees and shrubs that were removed at the park will be replaced with new trees and shrubs once construction of the Sewage Pumping Station is completed, with Lions' Club Park being restored to its original, or better condition.

Anticipated Construction Completion: Spring 2025

**Timeline is subject to change.*

MAP OF THE ERIN SEWAGE PUMPING STATION SITE WORK AREA

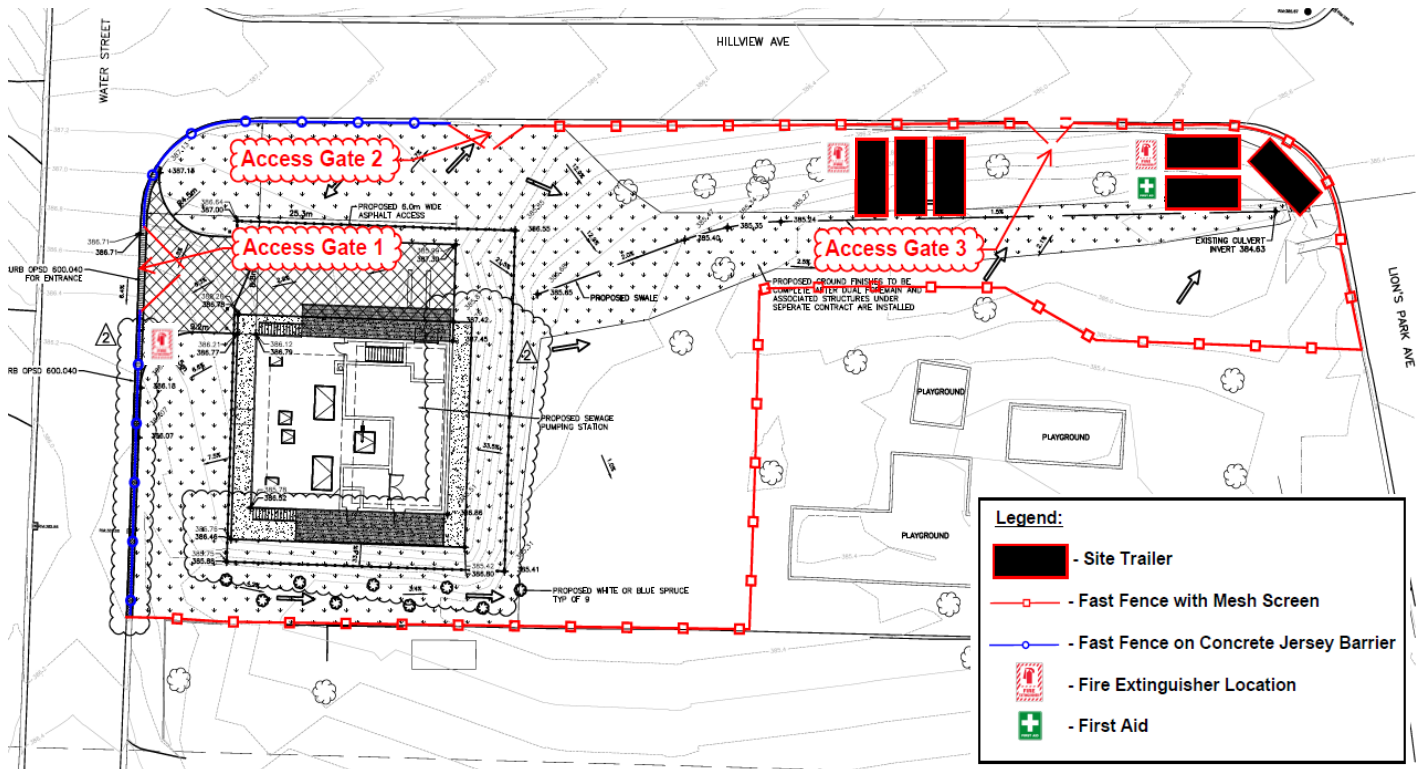



Construction Notice

WHAT TO EXPECT DURING TREE REMOVAL IN THE PARK

- You may experience inconveniences such as restrictions to park areas, increased truck traffic around the park, dirt on roads, dust and noise. The Town, along with the Contactor, will make every effort to minimize these impacts to the community.
- The Town will not be responsible for damage to any privately owned items on Town or County property.

	Work Hours: Work will take place from 7:00 a.m. to 7:00 p.m., Monday to Friday. Work after hours or on weekends may be required during the course of construction.
	Area Restrictions: To complete the work in a safe manner, there will be restrictions around the park area. The Town's Contractor will be erecting temporary fencing around the construction site; unauthorised access to the fenced area by the public is prohibited.

We appreciate your understanding and patience

MORE INFORMATION AND CONSTRUCTION UPDATES

We apologize for any inconvenience caused and thank you for your cooperation and patience as we work to improve the infrastructure in Erin Village. The Town and their Contractor will make every effort to minimize impacts to the community during construction. **Local businesses will remain open and accessible throughout the construction period.**

For any questions or concerns, please reach out to us via the following means:



digerin@erin.ca



519-855-4407 ext. 262 (8:30 AM – 4:30 PM)

1-888-861-2447 (After Hours & Weekends)



www.erin.ca

PLEASE FOLLOW THE TOWN'S SOCIAL MEDIA FOR CONSTRUCTION UPDATES

