



# Construction Liaison Meeting

## Erin Wastewater Servicing Project

### Project Update

December 18, 2024

# Construction Work Areas

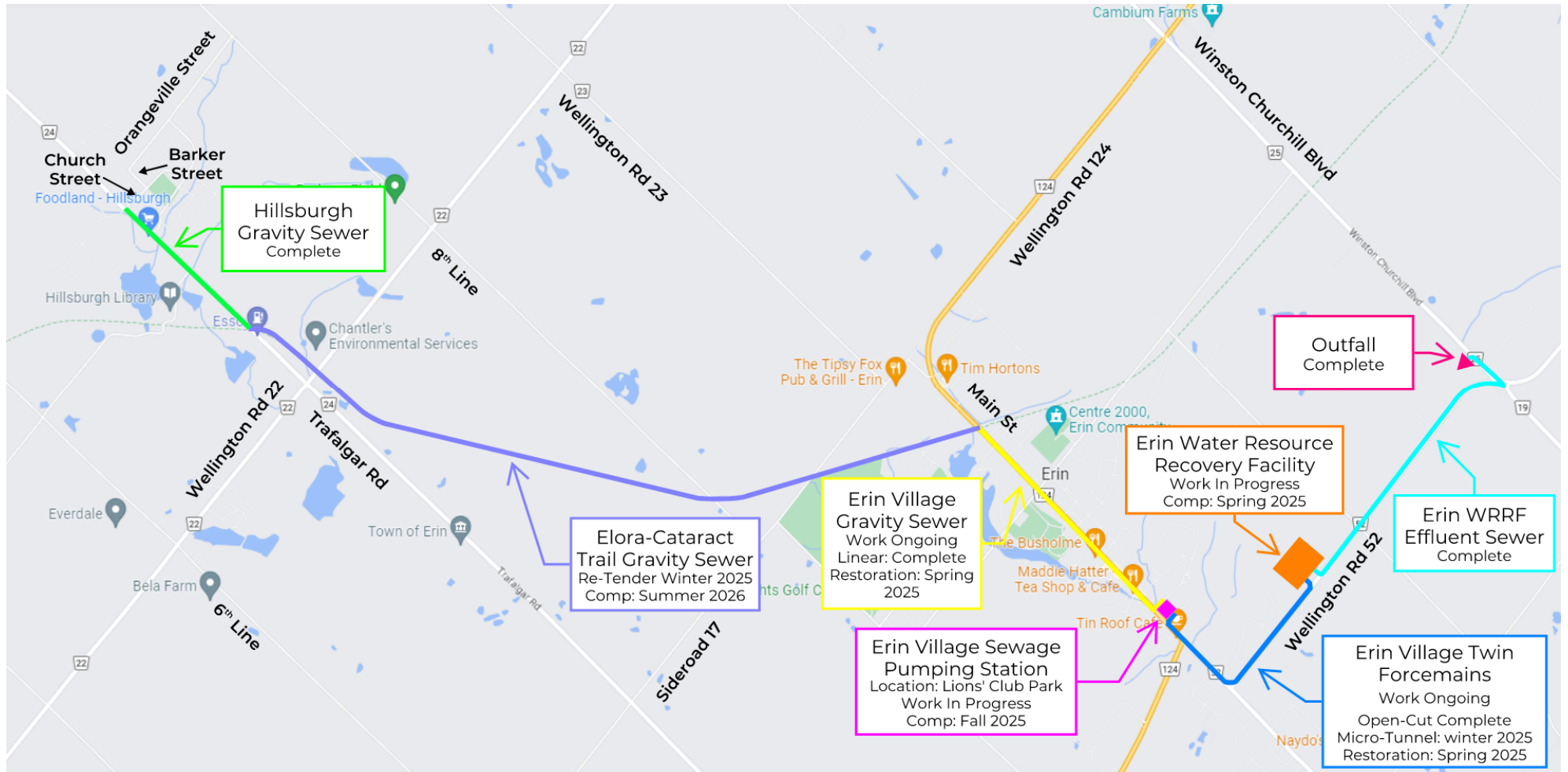

# Hillsburgh Gravity Sewer - Complete



**BUSINESSES ARE**  
**OPEN**  
**DURING CONSTRUCTION**



# Elora Cataract Trail Gravity Sewer

The planned construction along the Elora Cataract Trail will occur between Trafalgar Road and Main Street / Wellington Road 124, **connecting the future Hillsburgh and Erin Village wastewater collection systems** via gravity sewer. A new watermain connecting Hillsburgh to the water distribution system in Erin Village will also be installed, and twenty-six (26) culverts crossing the trail between Hillsburgh and Erin Village will be upgraded.

Due to the open-cut construction method required for the installation of the gravity sewer along the Trail, the Town’s Contractor will have to remove trees and shrubs along the pipe alignment. **Tree removals have been minimized to the greatest possible extent.**

Once the gravity sewer installation is completed, the Trail pathway will be restored to a better condition and all trees that are removed will be replaced with approximately four times as many new trees. In all, approximately **20,000 trees will be planted** back onto the trail and on other properties within the Town

**Tree Removals**

Tree removal work has been completed.

Installation of construction site/ erosion control fencing and erosion control blankets is complete.

**Culvert Upgrades & Linear Works**

The culvert upgrades and linear work is anticipated to start Spring 2025.

It is anticipated that the culvert and linear works will be completed by the summer of 2026, including all restoration.

**Trail Status**

The Elora-Cataract Trail is currently closed and will be closed for the duration of the culvert upgrades and linear works.

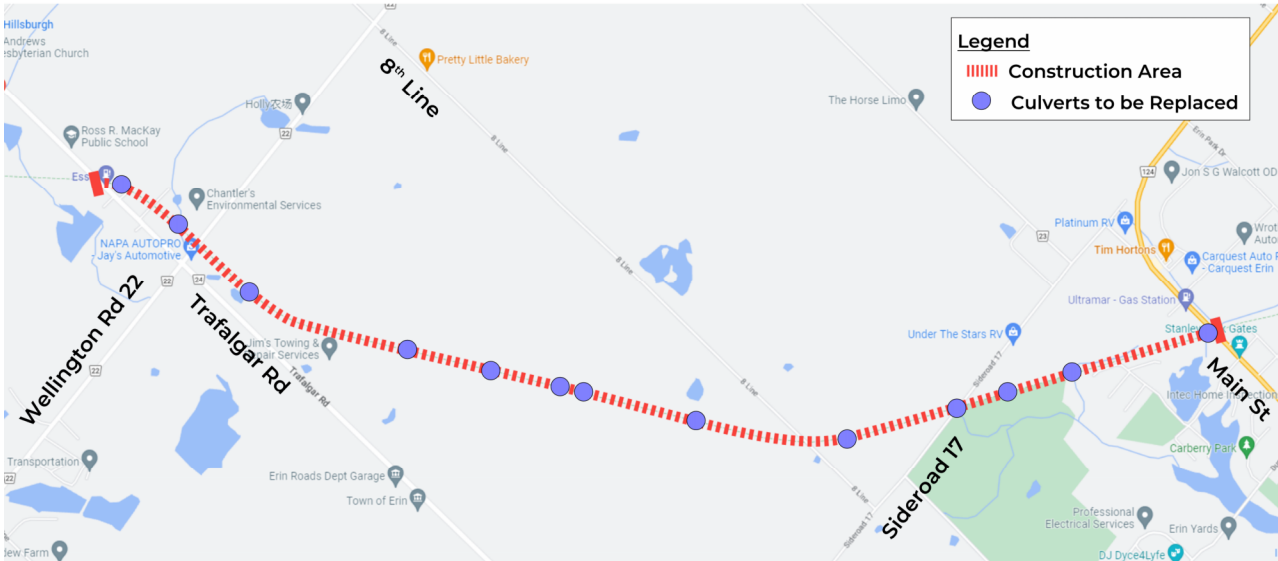

# Erin Village Gravity Sewer & Twin Influent Forcemains

The sanitary gravity sewer and twin forcemain construction in Erin Village along Main Street between the Elora Cataract Trail and Dianne Road, and along Water Street, commenced in July 2023.

The sewer installation will utilize microtunneling, a **trenchless pipe installation method**. As part of this process, microtunneling shafts will be installed at specific locations along Main Street, as indicated on the map below.

**Two-way traffic flow** and pedestrian access will be maintained on Main Street throughout the course of construction, and **road jogs will be implemented** where necessary to accommodate the shaft construction. Lane or road closures may be required on certain local roads to facilitate construction. **Access to local homes, businesses & emergency services will be maintained at all times.**

## Micro-Tunneling Work

All micro-tunneling shafts along Main St. are complete.

Tunneling work is complete from Shafts 1 to 6.  
Tunnelling work from Shaft 6 to SPS is complete.  
Tunneling work from Shaft 6 to 8 in progress.

It is anticipated that all micro-tunneling work will be completed in the Winter 2025 with some of the restoration works to be completed in Spring 2025.

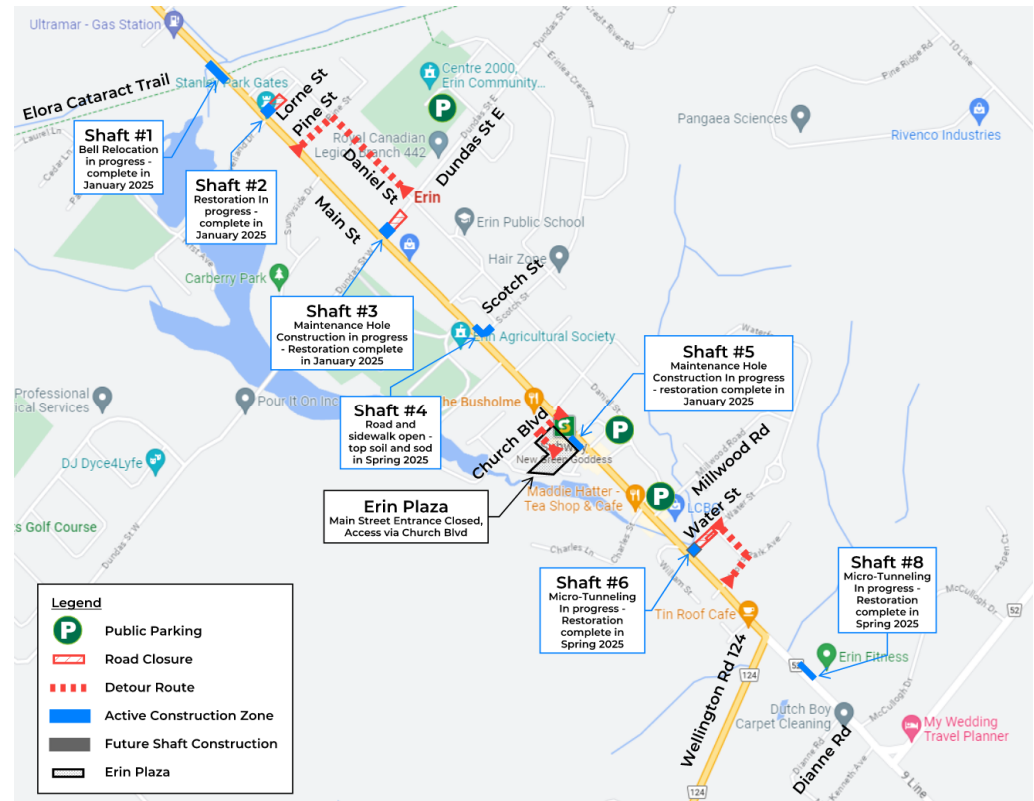

# Erin Village Gravity Sewer & Twin Influent Forcemains



Following is the Shaft Restoration Status.

ERIN LINEAR WORKS						
MAIN ST. MICRO-TUNNELING						
SHAFTS RETORATION STATUS						
SHAFT #	LOCATION - SEE PLAN	MICRO-TUNNELLING STATUS	MAINTENANCE HOLE CONSTRUCTION STATUS	SHAFT REMOVAL	RESTORATION STATUS	ANTICIPATED RESTORATION COMPLETION
1	MAIN ST. AT TRAIL	COMPLETE	COMPLETE	COMPLETE	IN PROGRESS	LATE JANUARY 2025 - BELL RELOCATION IN 2024
2	MAIN ST. AT LORNE ST.	COMPLETE	COMPLETE	COMPLETE	IN PROGRESS	LATE JANUARY 2025 - TOGETHER WITH MH#1
3	DUNDAS ST. E. AT MAIN ST.	COMPLETE	IN PROGRESS - DONE EARLY JAN 2025	IN PROGRESS - DONE EARLY JAN 2025	NO STARTED	LATE JANUARY 2025
4	MAIN ST. AT SCOTCH ST.	COMPLETE	COMPLETE	COMPLETE	IN PROGRESS	TOPSOIL & SOD SPRING 2025 - ROAD AND SIDEWALK OPEN
5	MAIN ST. IN FROM OF PLAZA	COMPLETE	IN PROGRESS - DONE EARLY JAN 2025	IN PROGRESS - DONE EARLY JAN 2025	NOT STARTED	LATE JANUARY 2025
6	WATER ST. AT MAIN ST.	IN PROGRESS	NOT STARTED	NOT STARTED	NOT STARTED	SPRING 2025
8	MAIN ST. SOUTH OF CREEK	IN PROGRESS	NOT STARTED	NOT STARTED	NOT STARTED	SPRING 2025

# Dundas St. East Gravity Sewer Developer Construction

The sanitary gravity sewer construction in Erin Village along Dundas St. East between Main Street and 10th Line commenced this Summer 2024.

The sewer installation will utilize both micro-tunneling, a **trenchless pipe installation method**, and open-cut construction. As part of this process, a micro-tunneling shaft has been installed in front of the Legion parking lot with temporary lights controlling two-way traffic through this area.

**Two-way traffic flow** and pedestrian access will be maintained along Dundas St. East throughout the course of construction. Lane or road closures may be required at certain times to facilitate construction. **Access to local homes, businesses & emergency services will be maintained at all times.**

Micro-Tunneling Work	The micro-tunneling installation work from in front of the Legion to Main St. has been completed.
	Restoration of the Main St. / Dundas St. E intersection is anticipated to be completed in January 2025.
Open-Cut Work	The open-cut installation work has started and includes the main sewer pipe and sanitary service connections to the property line.
	It is anticipated that the open-cut installation work will be completed by end of the year 2024.
	A shallow collection sewer will be installed along Dundas St. E. next year from Tomwell Crescent to Main St.

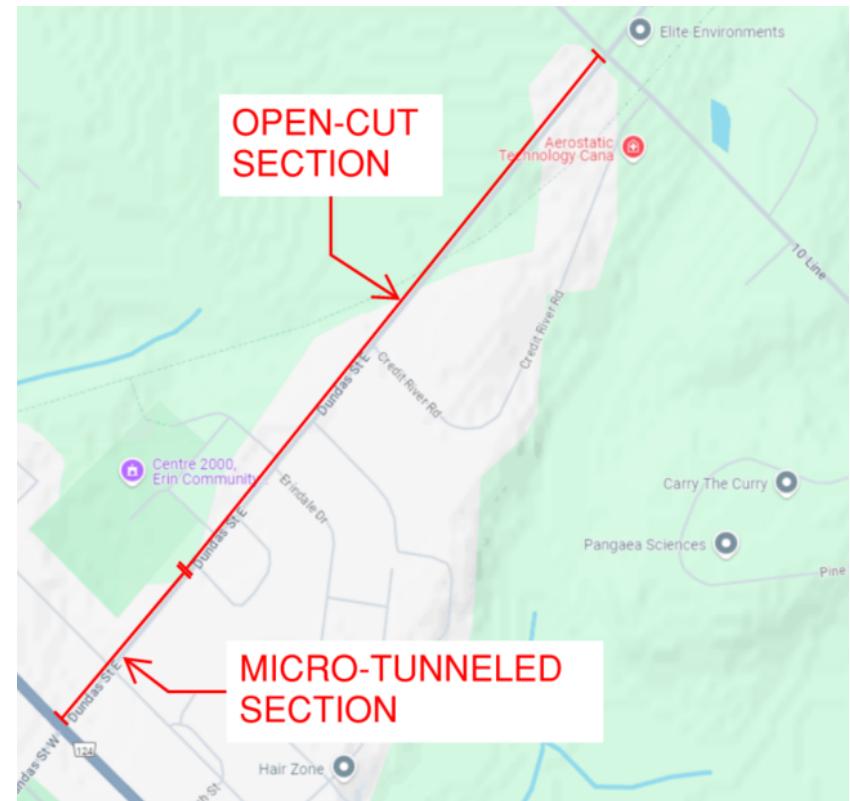

# Erin Village Sewage Pumping Station

The Erin Village Sewage Pumping Station, located at the **northeast corner of Lions' Club Park**, will convey wastewater to the Erin Water Resource Recovery Facility. The sewage pumping station has been designed to complement the natural features within the park and will be secured from access by the public.

This contract includes a **back-up emergency generator** located on the west side of Williams Street, just north of March Street.

To complete the work in a safe manner, there will be **restrictions around the Lions' Club Park and generator work areas**. The Town's Contractor will be erecting temporary fencing around the work area; unauthorized access to the fenced area is prohibited.

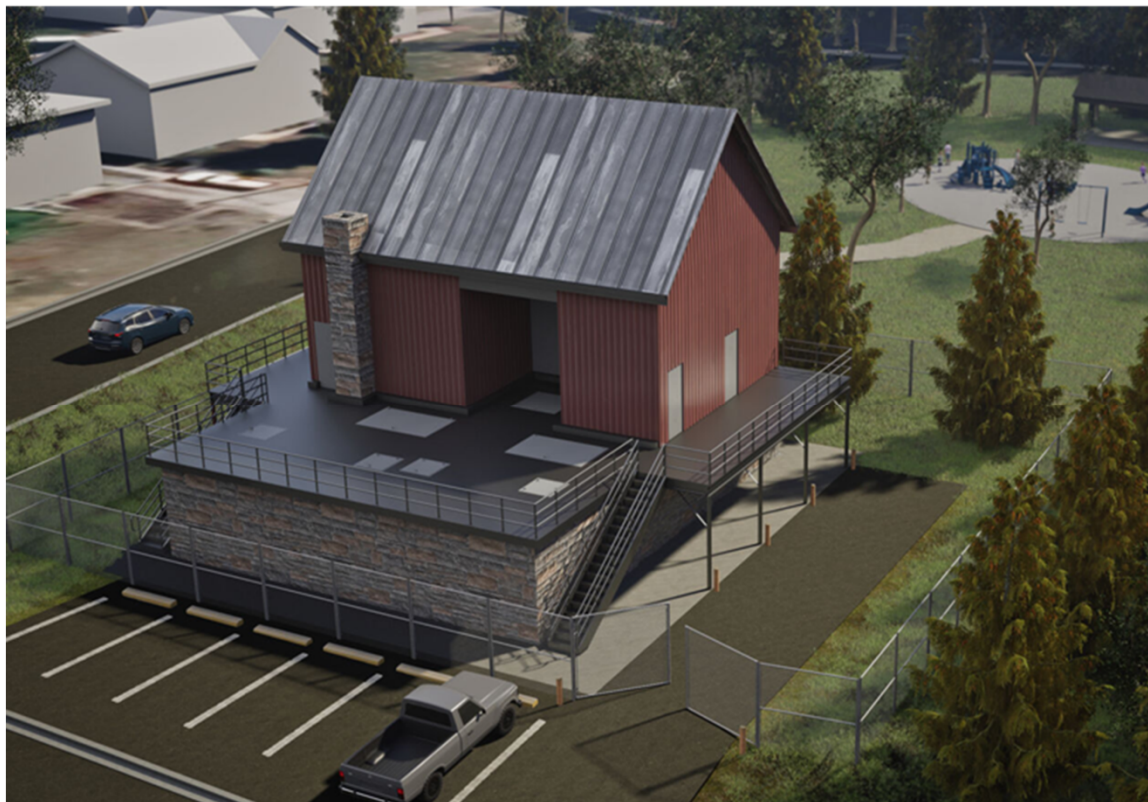

Sewage  
Pumping  
Station

Construction of the concrete work for the wet well is ongoing and anticipated to be completed early in the new year

Park

The entirety of Lions' Club Park is being used as the construction site and will be closed for the duration of construction.

Generator Site

Work at Generator Site is ongoing with a retaining wall and site works.

Fall 2025

**Sewage Pumping Station  
Completion**

The Park and generator sites will be restored to original or better condition



# Erin Water Resource Recovery Facility

The Erin Water Resource Recovery Facility is located on Wellington Road 52, west of 10<sup>th</sup> Line. The facility will treat the incoming raw wastewater from the Hillsburgh and Erin Village communities, producing treated effluent that achieves Ontario regulatory objectives and limits. The treated effluent will be discharged to the West Credit River via the effluent sewer and outfall that runs along Wellington Road 52 and Winston Churchill Boulevard.

The facility is designed to produce **one of the strictest discharge requirements in North America** and will include Canada's first municipal effluent cooling system to limit effluent discharge temperatures and ensure the coldwater aquatic habitat of the West Credit River will not be affected.

Construction work is **currently in progress** and is anticipated to be completed in the **Spring of 2025**.



## Major Works in Progress

- Site Works
- Mechanical, Electrical and Process piping
- Interior Finishes
- Cooling System – current status
  - Vendor shop drawing review
  - Equipment delivery in winter 2025
  - Installation of equipment in winter/spring 2025
  - Commissioning in spring of 2025





# Thank you for attending

All notices are also posted on the Town's Project Updates webpage

If you have additional questions, please contact us at:

 [digerin@erin.ca](mailto:digerin@erin.ca)

 (519) 855-4407 ext. 262

 [erin.ca](http://erin.ca)

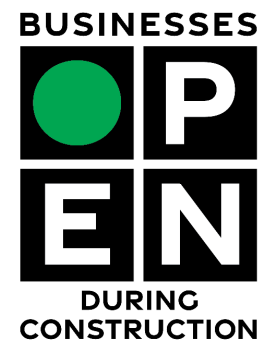

# Erin Village Twin Influent Forcemains

Twin forcemains extending from the Sewage Pumping Station in Lions' Club Park to the Erin Water Resource Recovery Facility will be installed along Lion's Park Avenue, Main Street (Wellington Road 124) and Wellington Road 52.

Installation of the linear infrastructure will mainly be completed via **open-cut trench method** with a small section installed by **microtunneling at the creek crossing** on Wellington Road 52, just south of Wellington Road 124.

**Temporary lane closures(s)** will be required along Wellington Road 124 and Wellington Road 52 between Lion's Park Avenue and the Erin Water Resource Recovery Facility

January 2023  
- Ongoing

### Construction Start

Road signage warning of lane closure and delays are in place along approach roads

Fall 2024

### Twin Influent Forcemain Construction

Forcemain installation & surface restoration work along Wellington Road 124 & Wellington Road 52 is anticipated to take 5 months

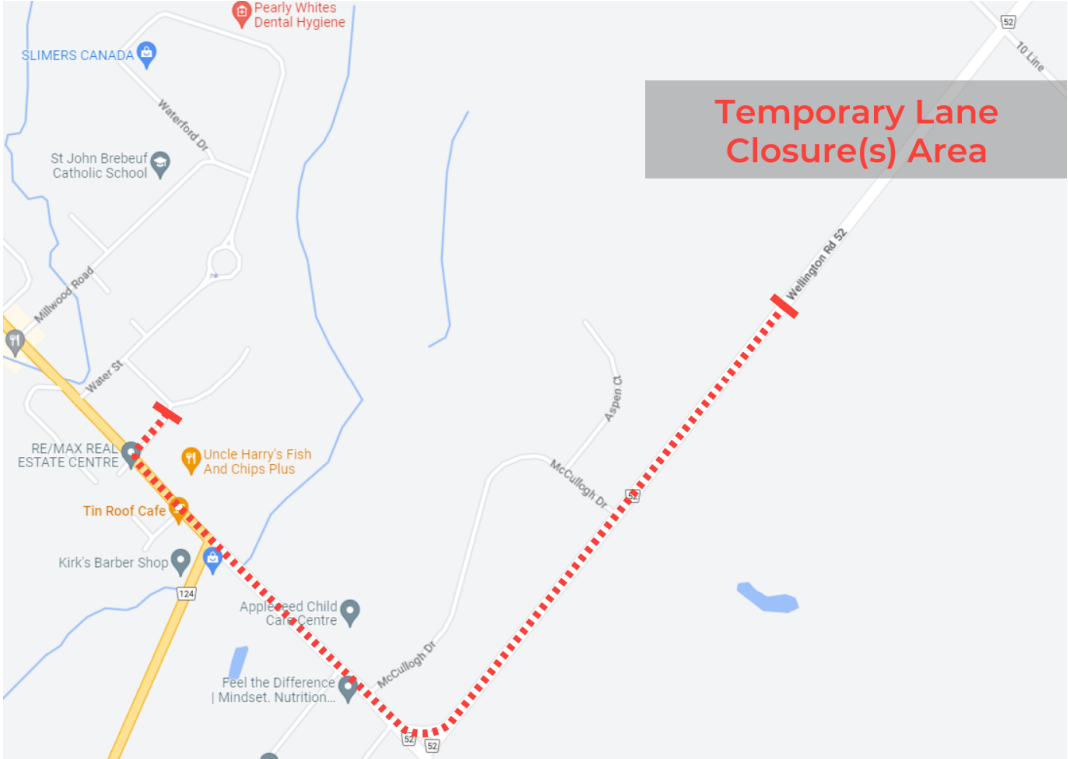

# WRRF Effluent Sewer

The effluent sewer will extend from the Erin Water Resource Recovery Facility, along **Wellington Road 52 and Winston Churchill Boulevard to the West Credit River.**

**Lane closures** will be required along Wellington Road 52.

**Road closures (local traffic only)** will be required on:

- Winston Churchill Boulevard, once work along Wellington Road 52 has been completed

Local access for residents, businesses and emergency vehicles will be maintained at all times

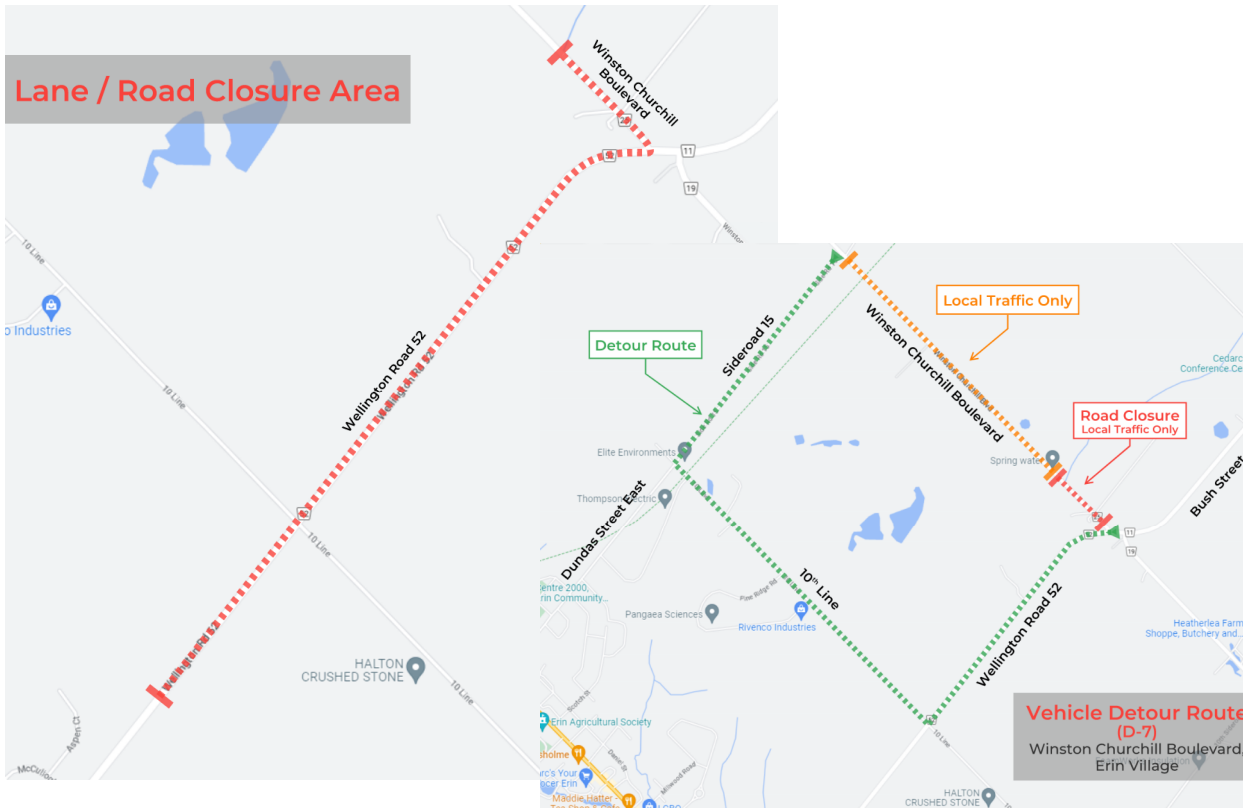

April 24, 2023  
– Ongoing

## Construction Start

Road signage warning of lane closure and delays are in place along approach roads

Signage for separate truck and vehicle detour routes are in place

## Construction Notices

Distributed to homes and businesses adjacent to the closed section of the road prior to the start of construction

September  
2023  
Completion  
(Anticipated)

## Effluent Sewer Construction

Forcemain installation & surface restoration work along Wellington Road 52 & Winston Churchill Boulevard is anticipated to take 5 months

# Anticipated Construction Schedule

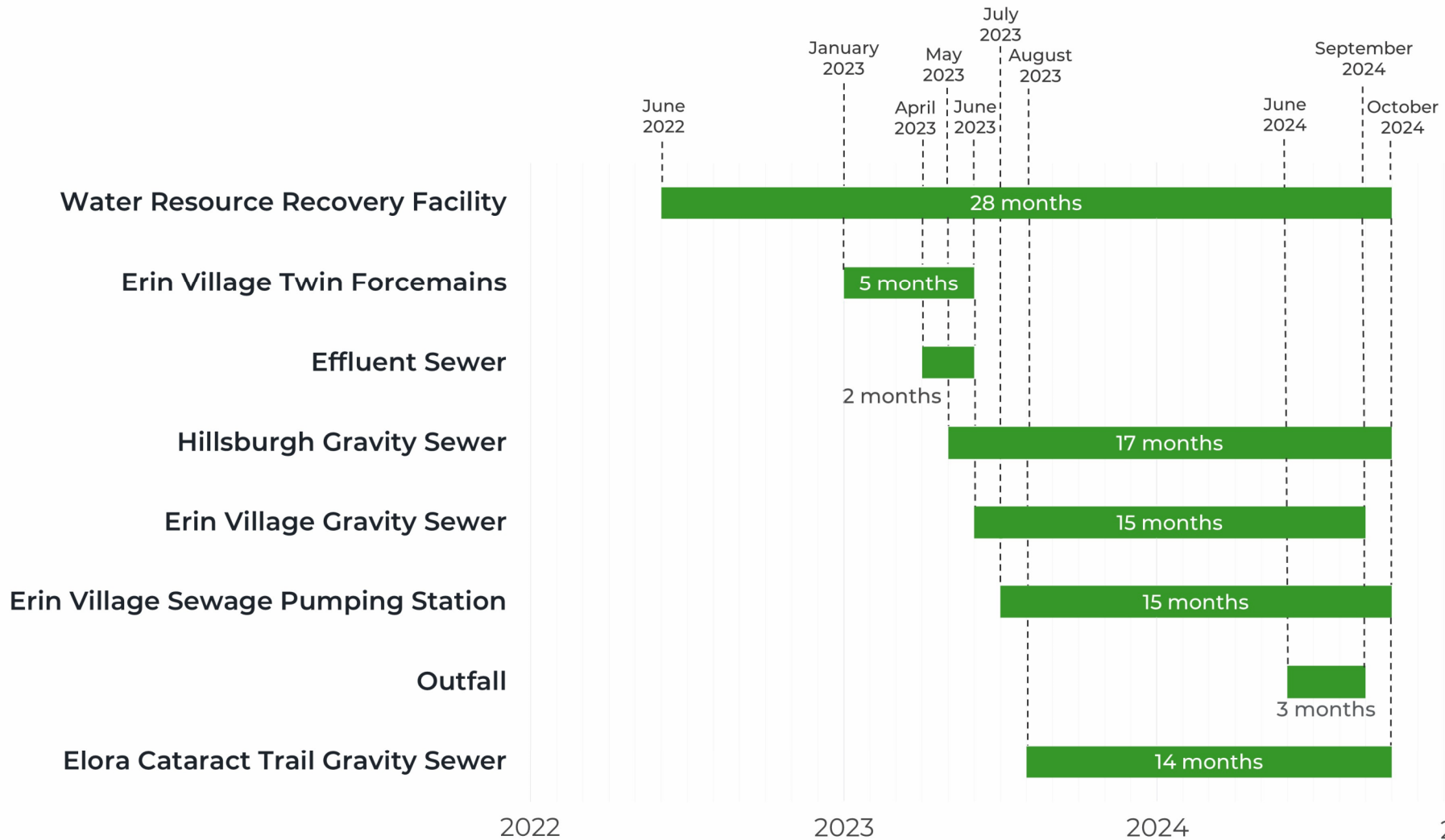

# 10<sup>th</sup> LINE & WINSTON CHURCHILL BLVD. ROAD CLOSURES

